

STAINLESS STEEL ROLLER CABINET

The stainless steel roller cabinet from EGA MASTER is the ideal solution for those environments which require increased levels of protection from pollution; such as the food and healthcare industries.



INOX

1. Each drawer provides easy transportation and storage, with increased levels of safety coming from the **Anti-overturn system** which has **individual safety**.

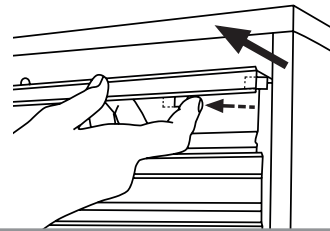

2. Manufactured in **high-quality steel**.

3. The **central locking system** ensures maximum anti-theft security and prevents undesired opening of the cabinet.



4. The reinforced heavy duty structure provides **320Kg of static capacity**.



5. Side handles for easier movement.

6. Different size drawers provide the maximum versatility for tool storage. **Equipped with ball bearings to ensure smooth and comfortable operation.**

7. **Four tough castors** enable smooth transportation, two of them have brakes and swivel.



STAINLESS STEEL ROLLER CABINET



COD

51478

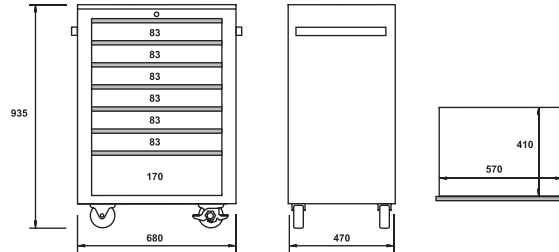

LxWxH

680x470x935



155

TECHNICAL SPECIFICATIONS

Material	Inox
7 Ball-bearing slides	●
2 fixed and 2 revolving with brake wheels	5"X1.5"
Capacity in 83mm height drawers	25 Kg
Capacity in 170mm height drawers	30 Kg
Total static weight capacity	320 Kg
Central locking system	●
Reinforced side handle	●
Anti-overturn system in each drawers	●

TECHNICAL SPECIFICATIONS

MATERIAL	Stainless Steel	
FINISHING	Side handles	Chrome metal