

ROLLER TOOL CABINETS

EGA MASTER roller cabinets are the ideal solution for tool storage in industrial environments, providing extra resistance and longer durability. Designed for the most demanding use, they offer smooth movement and maximum load capacity.



Available in 4 colors



14 Ball-bearing slides!

1. Each drawer provides easy transportation and storage, with increased levels of safety coming from the **Anti-overturn system** which has **individual safety opening buttons** on each drawer. (Upper chest).

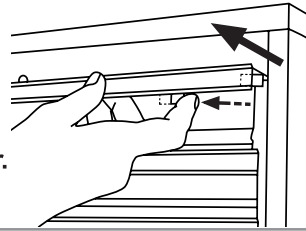

2. OODO Antioverturn System allows the user to open only one drawer each time. (Lower cabinet).

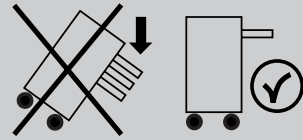

3. Manufactured in **high-quality steel**.

4. The **central locking system** ensures maximum anti-theft security and prevents undesired opening of the cabinet.

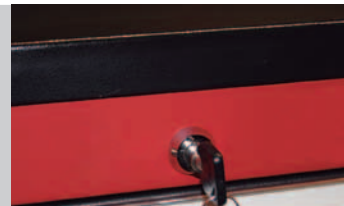

5. The reinforced heavy duty structure provides **560Kg of static capacity**, and the cabinet incorporates strong anti-shock bars.

6. The Roller Cabinet has a **folding side tray** that provides extra work space.



51075



51039

ROLLER TOOL CABINETS

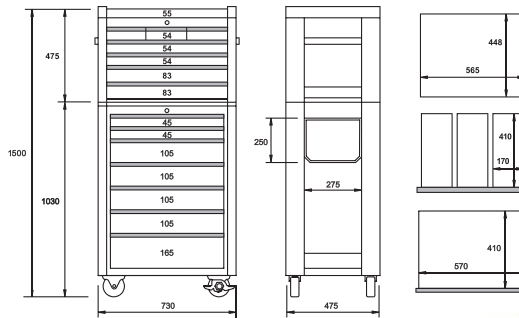

COD

LxWxH



51117	●	51039+51075	730x475x1500	97
51516	●	51486+51490		
51519	●	51498+51502		
51522	●	51510+51514		

TECHNICAL SPECIFICATIONS

14 Ball-bearing slides	●	
2 fixed and 2 revolving with brake wheels	5"X2"	
Chest	Capacity in 55mm height drawer	9 Kg
	Capacity in 170x410x54mm drawers	5 Kg
	Capacity in 570x410x54mm drawers	8 Kg
	Capacity in 85mm height drawer	10 Kg
	Total static weight capacity	60 Kg
Roller cabinet	Capacity in 45mm height drawers	30 Kg
	Capacity in 105mm height drawers	40 Kg
	Capacity in 165mm height drawers	50 Kg
Total static weight capacity	560 Kg	
Chest with side handles	●	
Central locking system	●	
Reinforced heavy duty structure	●	
Roller cabinet with lateral foldable tray	●	
Roller cabinet with lateral tool holder	●	
Anti-overturn system in each drawers	●	

TECHNICAL SPECIFICATIONS

MATERIAL	Steel	
FINISHING	Cabinet	Cod. 51117 Painted in epoxy powder Red RAL 2002 semitexturized Cod. 51516 Painted in blue RAL-5017* Cod. 51519 Painted in yellow RAL-1003* Cod. 51522 Painted in green RAL-6032*
	Front drawers	Painted in grey
	Side handles	Chrome metal

*Approximate colors