

# TUBE CUTTER FOR PLASTIC



The wide range of automatic Pipe cutters of EGA Master is designed for the easy and quick cut of different materials and sizes tubes, following the needs of the user. Its precision machining provides the quickest and smoothest action.

**Able to cut copper, inox and plastic pipes with the proper cutting wheels.**



## UNIQUE

**1. Designed for the cutting and reaming of plastic pipes, it is extremely robust, compact and easy to use.**

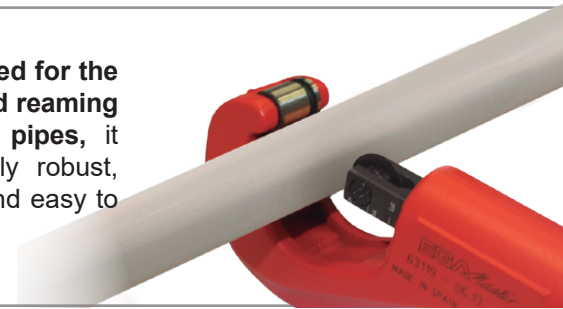

**2. Laser marked graduated scale to facilitate working action.**



**3. Extra cutting wheel at the knob.**



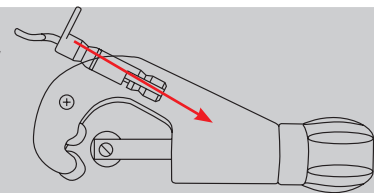

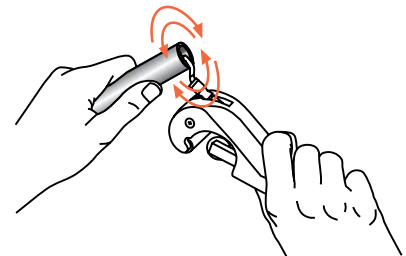
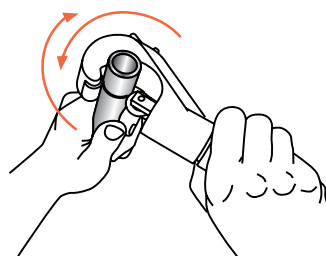
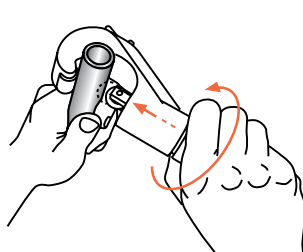

**4. Extractable reamer can work assembled in the tubing cutter or independently.**

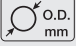
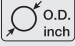

**5. Gold Medal, International Inventors Competition, Paris 2004.**



## UNIQUE

COD.	 O.D. mm	 O.D. inch	MAT.					
<b>63079</b>	6-35	1/4-1.3/8	PLASTIC	500	1	●	63112	10
<b>63120</b>	6-42	1/4-1.5/8		550	8			
<b>63189</b>	6-45	1/4-1.3/4		600	1			



TECHNICAL SPECIFICATION		
MATERIAL	Body, carriage and knob	Zinc alloy
	Cutting wheel	Special steel
	Reamer	Special steel
HARDNESS	Cutting wheel	55-60 Hrc
	Reamer	50-60 Hrc
FINISHING	Body	Painted in epoxy powder red color RAL-2002 Semi-texturized
	Knob	Painted in epoxy powder black color Semi-texturized
	Screw, cutting wheel and axle	Black finish
	Rollers	Black finish

## AUTOMATIC 50

COD.	 O.D. mm	 O.D. inch	MAT.					
<b>63365</b>	6-50	1/4-2	PLASTIC	450	1	●	63722	10



## AUTOMATIC 67

COD.	 O.D. mm	 O.D. inch	MAT.					
<b>63108</b>	6-67	1/4-2.5/8	PLASTIC	750	1	●	63081	10



## AUTOMATIC 127

COD.	 O.D. mm	 O.D. inch	MAT.					
<b>63173</b>	50-127	2-5	PLASTIC	1950	1	●	64105	10



TECHNICAL SPECIFICATION		
MATERIAL	Body, carriage and knob	Aluminium alloy
	Cutting wheel	Special steel
	Reamer	Special steel
HARDNESS	Cutting wheel	55-60 Hrc
	Reamer	50-60 Hrc
FINISHING	Body	Painted in epoxy powder red color RAL-2002 Semi-texturized
	Knob	Painted in epoxy powder black color Semi-texturized
	Screw, cutting wheel and axle	Black finish
	Rollers	Black finish