

1" SOCKET WRENCHES

EGA Master offers a wide range of socket wrenches, both shallow and deep range series, together with a large number of additional and complementary items, such as adapters, hinged handles, extensions, ratchet wrenches, etc.

1/4", 3/8", 1/2", 3/4" and 1" square drive hand-operated sockets and 3/8", 1/2", 3/4", 1", 1.1/2", 2.1/2" and 3.1/2" square drive impact sockets wrenches, being the only in the sector offering such a wide range.



both in mm and inches

- 6 or 12 edges.



The sockets are made of **chrome-vanadium steel**, designed to withstand high tightening torques with minimal wear, providing the same greater durability.

SOCKET WRENCHES

1"

mm



COD X	mm	L	A	B	C	MINIMUM TORQUE	gr.	
65001	36mm	65	50		32	1500	500	
65002	41mm	70	55	45	35	1800	600	
65003	46mm	75	65	50	39	2143	850	
65004	50mm		70		41	2329	1050	5
65005	54mm					2450	1150	
65006	55mm	80	75		42	2562	1250	
65007	58mm					2600	1300	
65008	60mm		80	55			1400	1
65009	63mm	85	85		47		1500	
65010	65mm						1550	
65011	67mm	90	90		50		1650	
65012	70mm					2795		4
65013	71mm	95	95		55		2050	
65014	75mm		100	70			2400	
65015	77mm							
65016	80mm	105	105		60		2550	

UNE16501:2009, ISO 1711-1 Cr-V DIN 3124

- x 50% aerospace chrome plating
- 50% mirror polished chrome plating
- y 100% mirror polished chrome plating

SOCKET WRENCHES

1"

Inch.

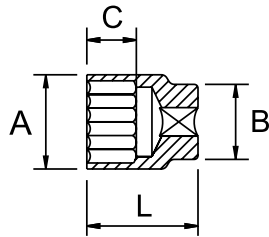

COD X	AF	L	A	B	C	MINIMUM TORQUE	gr.		
65022	1.5/8"	70	55	45	35	1800	550		
65023	1.13/16"			50		2143	800		
65024	1.7/8"	75	65			2250	950		
65025	2"		70		37	2329	1000	5	
65026	2.1/8"		75			2450	1100		
65027	2.3/16"	80		55		2562	1150		
65028	2.1/4"		80		43	2600	1200		1
65029	2.3/8"		80		45		1300		
65030	2.1/2"	85	85		48		1400		
65031	2.5/8"	90	90		50	2795	1550		
65032	2.3/4"	95	95		55		1950	4	
65033	3"			70					
65034	3.1/8"	105	105		60		2450		

UNE16501:2009, ISO 1711-1 Cr-V DIN 3124

ADAPTER



COD	1"	gr.		
65040	1-3/4"	430	6	1

SWIVEL HANDLE



COD		L	Kg.	
61474	1"	1000	4,0	6
61457	1"	650	2,5	6

REVERSIBLE RATCHET HANDLE



COD		L	gr.	
65035	1"	650	4400	1

SLIDING "T" HANDLE



COD		L	gr.	
65036	1"	550	3300	1

DIN 3122

UNIVERSAL JOINT



COD		gr.		
65039	1"	1200	4	1

DIN 3123

LIFETIME GUARANTEE

EXTENSION



COD	1"	← L →	gr.	5
65037	8"	200	1150	5
65038	16"	400	2300	

DIN 3123

TECHNICAL SPECIFICATIONS

MATERIAL	Cr-V
MINIMUM HARDNESS	44 HRC
FINISHING	CHROME

SETS

1"

14pcs

mm = inch. =



COD

C



65041	36-41-46-50-55-60-65-70-75-80mm	8"/16"			
65042	1.13/16"-1.7/8"-2"-2.3/16"-2.1/4"-2.3/8"-2.1/2"-2.5/8"-2.3/4"-3.1/8"	8"/16"	●	●	● 27



LIFETIME GUARANTEE