

# WRENCH SLOGGING RING

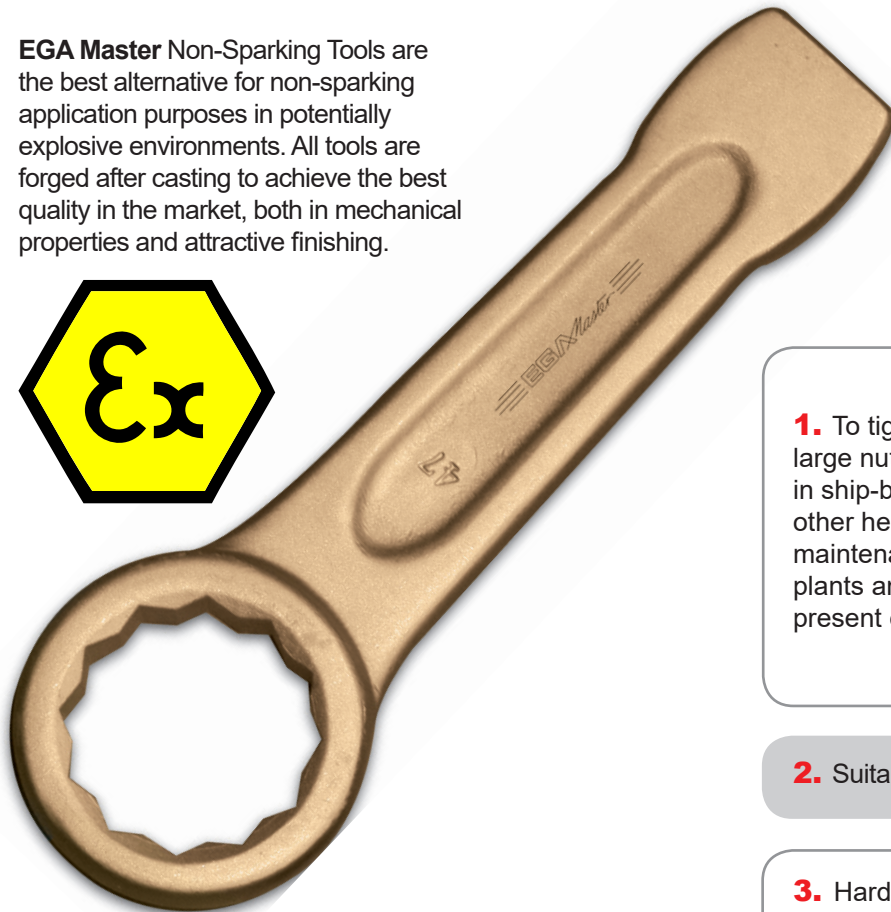

EGA Master Non-Sparking Tools are the best alternative for non-sparking application purposes in potentially explosive environments. All tools are forged after casting to achieve the best quality in the market, both in mechanical properties and attractive finishing.



**1.** To tighten or loosen large nuts and bolts in ship-building and other heavy industries, maintenance of industrial plants and areas that present explosion risks.



**2.** Suitable to be used with hammer or mallet.

**3.** Hardness: 283-365 Brinell (Cu-Be) and 229-291 Brinell (Al-Bron).

## SLOGGING RING MM

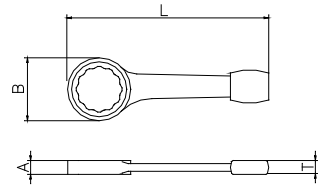

COD		B	L	Kg.
Cu-Be	Al-Bron			
70297	71080	17mm	147	0,13
70298	71081	19mm		
72231	72230	20mm		
70299	71082	22mm	172	0,231
70300	71083	24mm		
72631	72677	25mm		
71906	72951	26mm	180	0,29
70301	71084	27mm		
72633	72679	28mm		
72634	72680	29mm	190	0,39
70302	71085	30mm		

COD		B	L	Kg.
Cu-Be	Al-Bron			
72635	72681	31mm	190	0,39
70303	71086	32mm		
72609	72619	33mm		
73326	73331	34mm	200	0,525
72610	72620	35mm		
70304	71087	36mm		
72611	72621	37mm	225	0,505
71834	71835	38mm		
72636	72682	39mm		
73327	73332	40mm	225	0,762
70305	71088	41mm		

Cu-Be beryllium copper      Al-Bron aluminium bronze

**SLOGGING RING MM**

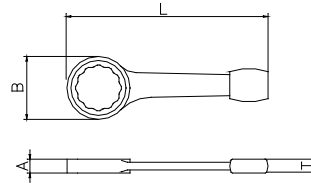

COD		mm	L	Kg.
Cu-Be	Al-Bron			
73328	73333	42mm	225	0,78
72638	72684	43mm	235	0,925
73329	73334	44mm		
72640	72686	45mm		
70306	71089	46mm		
72229	72228	47mm	245	1,135
73330	73335	48mm		
72642	72688	49mm	265	1,39
70307	71090	50mm		
72643	72689	51mm		
70308	71091	52mm		
72644	72690	53mm	275	1,655
72613	72623	54mm		
70309	71092	55mm		
73470	73394	56mm		
72647	72693	57mm	290	1,96
73471	73395	58mm		
72648	72694	59mm		
70310	71093	60mm		
72650	72696	61mm	320	2,46
72651	72697	62mm		
72652	72698	63mm		
72653	72699	64mm		
70311	71094	65mm	325	2,675
72655	73340	66mm		
72615	72625	67mm		
72656	72702	68mm		
72657	72703	69mm	325	2,675
70312	71095	70mm		
72616	72626	71mm		
72658	72704	72mm		
72659	72705	73mm	325	2,675
72660	72706	74mm		

COD		mm	L	Kg.
Cu-Be	Al-Bron			
70313	71096	75mm	325	2,675
72662	72708	76mm		
72617	72627	77mm		
72663	72709	78mm		
72664	72710	79mm	345	3,005
70314	71097	80mm		
72665	72711	81mm		
72666	72712	82mm		
72667	72713	83mm	350	3,27
72668	72714	84mm		
70315	71098	85mm		
72670	72716	86mm		
72671	72717	87mm	375	3,81
72672	73342	88mm		
72673	72719	89mm		
70316	71099	90mm		
72675	72721	92mm	395	4,5
72618	72628	94mm		
70317	71100	95mm		
73345	73344	98mm		
70318	71101	100mm	405	5,5
71074	71102	105mm		
71075	71103	110mm		
71076	71104	115mm		
71077	71105	120mm	410	6,5
71078	71106	125mm		
71079	71107	130mm		
72084	72089	135mm		
72085	72090	140mm	435	8,5
72086	72091	145mm		
72087	72092	150mm		
72088	72093	155mm		
72212	72210	160mm	565	14,1
			595	15,98

Cu-Be **beryllium copper**      Al-Bron **aluminium bronze**

**SLOGGING RING INCH.**

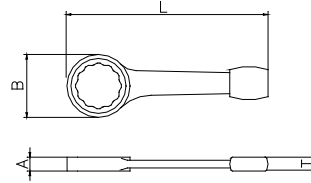

COD		Ø	L	Kg.
Cu-Be	Al-Bron			
72121	72127	5/8"	147	0,1316
71108	71133	11/16"		
71109	71134	3/4"	172	0,13536
71110	71135	7/8"		
75400	72303	15/16"	180	0,2162
71111	71136	1"		
71112	71137	1.1/16"	190	0,2914
72122	72128	1.1/8"		
71113	71138	1.3/16"	190	0,41924
71114	71139	1.1/4"		
75397	71789	1.5/16"	200	0,4606
72123	72129	1.3/8"		
71115	71140	1.13/32"	200	0,51136
72301	71791	1.7/16		
72124	72130	1.1/2"	225	0,5076
75398	71793	1.9/16"		
71116	71141	1.5/8"	225	0,78396
75406	71794	1.11/16"		
72125	72131	1.3/4"	235	0,95316
71117	71142	1.13/16"		
72126	72132	1.7/8"	245	1,1468
75399	71797	1.15/16"		
71118	71143	2"	265	1,1468
75401	71798	2.1/16"		
75402	71799	2.1/8"	265	1,363
72954	71800	2.3/16"		
75403	75404	2.13/64"	275	1,6732
71119	71144	2.1/4"		
71120	71145	2.5/16"	275	1,6732
71121	71146	2.3/8"		
75405	71801	2.7/16"	290	1,045

COD		Ø	L	Kg.
Cu-Be	Al-Bron			
71122	71147	2.1/2	290	1,9646
71123	71148	2.9/16"		
71124	71149	2.5/8"	320	2,4628
71125	71150	2.3/4"		
77258	77259	2.13/16"	325	2,6602
71126	71151	2.15/16"		
71127	71152	3"	345	2,9986
71128	71153	3.1/16"		
71129	71154	3.1/8"	350	3,337
77260	77261	3.1/4"		
71130	71155	3.3/8"	375	3,807
76850	76851	3.1/2"		
71131	71156	3.9/16"	395	4
76849	76852	3.5/8"		
71132	71157	3.3/4"	405	5,5
74335	75407	3.7/8"		
75408	75409	3.15/16"	410	6,5
77262	77263	4"		
75410	75411	4.1/8"	435	8,5
74331	74332	4.1/4"		
77264	77265	4.5/16"	475	10
75412	75413	4.1/2"		
77266	77267	4.9/16"	490	10,81
75414	75415	4.5/8"		
75416	75417	4.11/16"	505	11,28
74333	74334	4.7/8"		
77268	77269	4.15/16"	555	12,22
77270	77271	5.1/8"		
77272	77273	5.3/8"	565	13,63
77274	77275	5.11/16"		
77276	77277	6"	565	14,1

Cu-Be **beryllium copper**      Al-Bron **aluminium bronze**