

AXIAL GRIP PLIERS

EGA Master's axial grip pliers, for welding and soldering operations, are ideal for access into difficult places or areas with restricted space. They have a smooth action and are a compact tool for steel fabrication, sheet metal and auto body works.

Simple one handed operation!

1. The longitudinal movement of the jaws allows panel adjustment without dismantling.

2. The narrow jaws allow access into confined spaces.

3. Great ergonomics with a comfortable operation.

4. One handed unlocking thanks to the push button release system.



TECHNICAL SPECIFICATIONS

MATERIAL	Body: Special Steel / Jaws: Cr-Mo
HARDNESS	Jaws: 45 +/- 5 HRc
FINISH	Handle: Nickel plated / Jaws: Black

AXIAL GRIP PLIERS

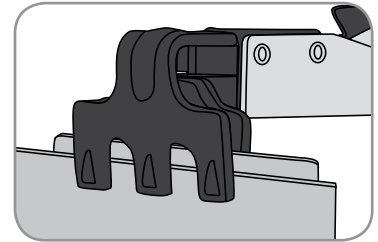
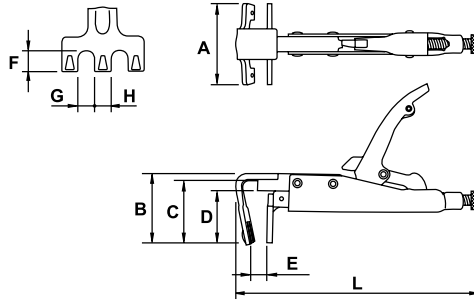
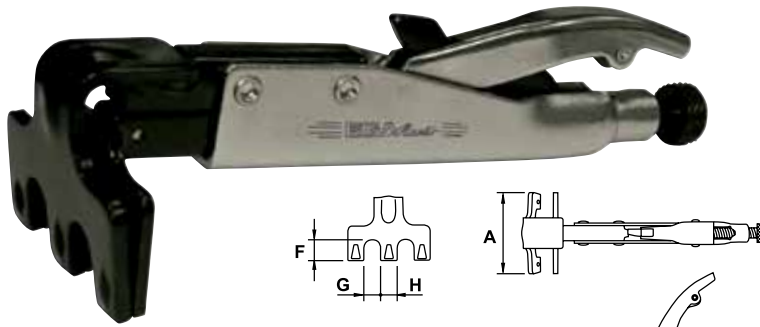

Wide and flat jaws to clamp lap joints and allow four consecutive spot welds without moving the tool

COD	TYPE	L	A	B	C	D	E	F	G	H	gr	
56180	W	200	70	56	53	40	12	18	14	14	550	1

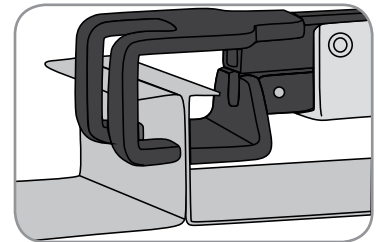
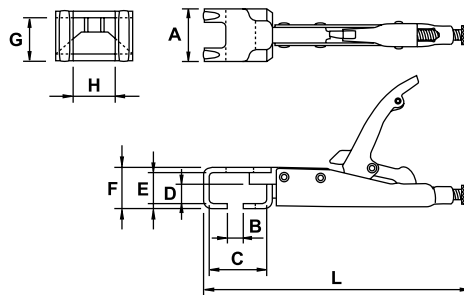
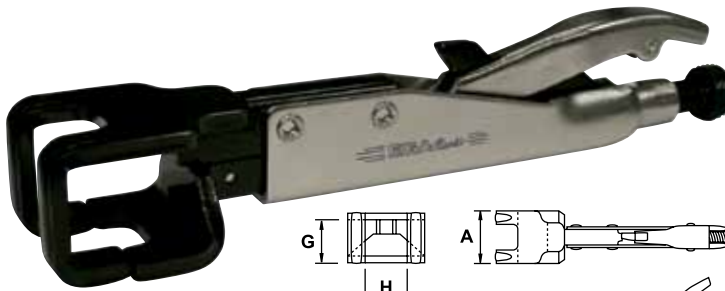

Double angle jaws to clamp 90° flanged, lapped or adjacent joints

COD	TYPE	L	A	B	C	D	E	F	G	H	gr	
56181	JJ	212	46	13	49	17	26	37	31	20	550	1

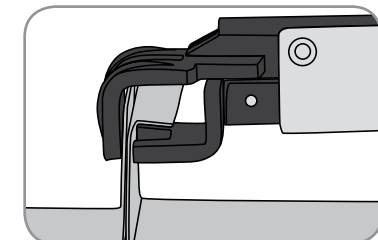
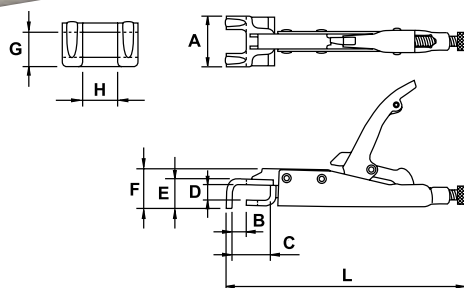
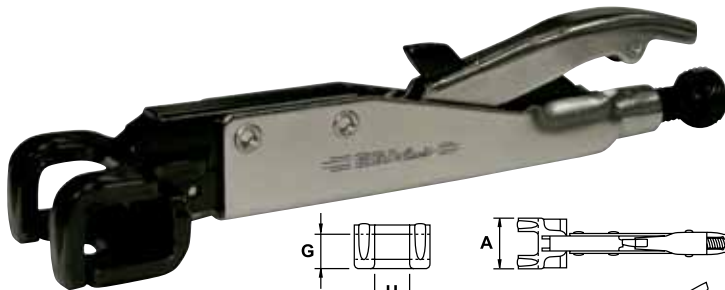

Wide angled jaws to spot-weld butt or adjacent sheet metal joints, will accommodate a 90° flanged joint

COD	TYPE	L	A	B	C	D	E	F	G	H	gr	
56182	LL	212	46	13	34	14	26	37	21	21	550	1

AXIAL GRIP PLIERS

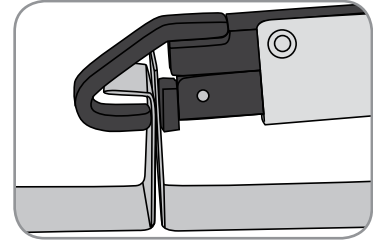

Angled jaws to clamp 90° flanged lap sheet metal joints

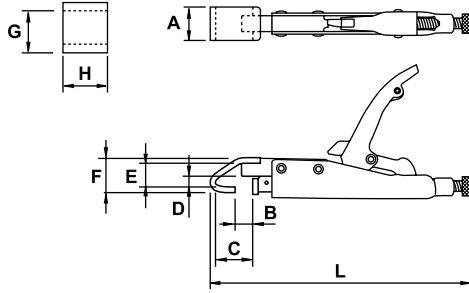

COD	TYPE	L	A	B	C	D	E	F	G	H	gr.	
56183	J	212	25	14	31	9	19	31	24	25	550	1

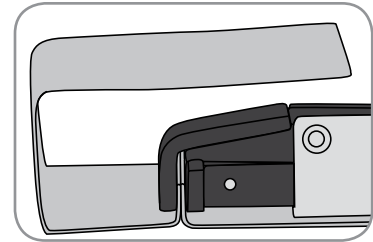

Straight jaws which are ideal for clamping flat lap sheet metal joints

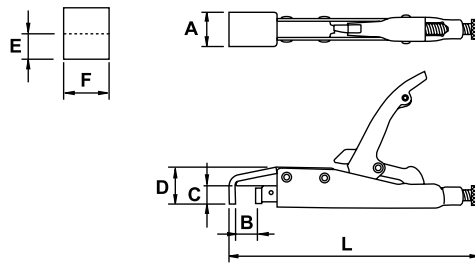

COD	TYPE	L	A	B	C	D	E	F	gr.	
56184	L	196	25	14	13	30	13	25	550	1