

# SOCKETS 1/4" 1000V



EGA Master insulated tools comply with IEC 60900 international standard, each one of the pieces being tested at 10,000V (10 times the voltage we certify). They are also tested rigorously according to what the norms establishes: adherence test, impact test, flame propagation test and dielectric penetration test.



## MAIN APPLICATION FIELDS

<b>Electrical installation</b>	High Voltage networks	Electric maintenance
<b>Power Plants</b>	Low Voltage networks	Fire-fighters
<b>Electric Stations and substations</b>	Telecommunications	Lighting installation and repair

## CAUTION

- 1 Don't ever use tools under voltage if they present pores, fissures, encrusted elements or if the white insulation layer is visible.
- 2 **Insulating floors and safety shoes** are recommended to work under voltage.
- 3 **Avoid contact with water** while working under voltage.
- 4 **Do not ever touch directly any item that may be under voltage.** Use a voltage tester to check first.

# SOCKETS 1/4"

## 1000V

EGA Master offers a wide range of 1000V insulated sockets, both short range and long series offering in turn a large number of additional items, such as adapters, articulated handles, extensions, ratchets, etc.

There are ranges of 1/4", 3/8" and 1/2" square driver for the most demanding professionals.



both in mm  
and inches

1. Sockets with 6 and 12 edges both in mm and in inches to suit user's needs.



2. Made of chrome-vanadium steel, designed to support high torques with minimum wear out, providing greater durability.

3. The insulation provides maximum adherence and safety against unforeseen circumstances.

4. Un-erasable laser marking.

### SOCKET WRENCHES 1/4"

# 1/4"

mm



1.000V  
IEC 60900

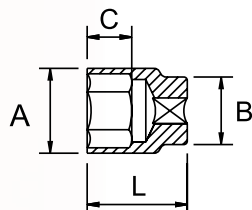

COD	AF	L mm	A	B	C	gr.
73230	4mm		11			
73228	4,5mm		12			
73231	5mm		13		11	15
73229	5,5mm		14			
73232	6mm	42	16	18		10
73233	7mm		17			
73234	8mm		18			
73235	9mm		19			
73236	10mm		21			25
73237	11mm		22		15	30
73238	12mm		23			35
73239	13mm					
73240	14mm					

UNE 16501:2009 (ISO 1711-1) Cr-V DIN 3124

SOCKET WRENCHES 1/4"

**1/4"**

mm



1.000V  
IEC 60900

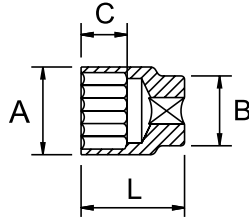

COD	AF	L mm	A	B	C	gr.
73241	4mm	42	11	18	11	15
73242	4,5mm					
74885	5mm					
74886	5,5mm					
74887	6mm					
74888	7mm					
74889	8mm					
74890	9mm					
74891	10mm					
74892	11mm					
74893	12mm	15	21	15	30	
74894	13mm					
74895	14mm					

UNE 16501:2009 (ISO 1711-1) Cr-V DIN 3124

**1/4"**

Inch.



1.000V  
IEC 60900

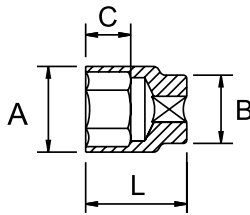

COD	AF	L mm	A	B	C	gr.
73366	5/32"	42	11	18	11	15
73367	3/16"					
73368	7/32"					
73369	1/4"					
73370	9/32"					
73371	5/16"					
73372	11/32"					
73373	3/8"					
73374	7/16"					
73377	15/32"					
73375	1/2"	15	21	15	30	
73376	9/16"					

UNE 16501:2009 (ISO 1711-1) Cr-V DIN 3124

**1/4"**

Inch.



1.000V  
IEC 60900

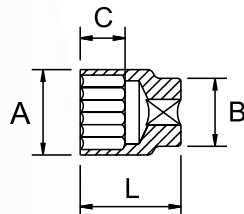

COD	AF	L mm	A	B	C	gr.
73365	5/32"	42	11	18	11	15
74900	3/16"					
74901	7/32"					
74902	1/4"					
74903	9/32"					
74904	5/16"					
74905	11/32"					
74906	3/8"					
74907	7/16"					
74910	15/32"					
74908	1/2"	15	21	15	30	
74909	9/16"					

UNE 16501:2009 (ISO 1711-1) Cr-V DIN 3124

TECHNICAL SPECIFICATIONS

MATERIAL	Socket wrenches	Cr-V
	Isolation	PP
MINIMUM HARDNESS	39 HRc	
FINISH	Isolated orange RAL 2009	

LONG SOCKET WRENCHES 1/4"

**1/4"**

mm



1.000V  
IEC 60900

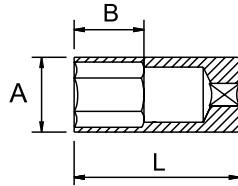

COD	AF	L mm	A	B	gr.		
75050	4mm	48	7,5	8,0	33	10	
75051	4,5mm		8,0				
75052	5mm		9,0				
75053	5,5mm		10				
75054	6mm		11	10			
75055	7mm		12				
75056	8mm		14				
75057	9mm		15				
75058	10mm		12	12			46
75059	11mm						50
75060	12mm	55					
75061	13mm	65					
75062	14mm	20					

UNE 16501:2009 (ISO 1711-1) Cr-V DIN 3124

**1/4"**

mm



1.000V  
IEC 60900

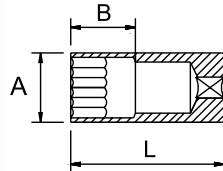

COD	AF	L mm	A	B	gr.		
75070	5mm	48	9,0	80	33	10	
75071	5,5mm		10				
75072	6mm		11				
75073	7mm		12	10			
75074	8mm		14				
75075	9mm		15				
75076	10mm		17				
75077	11mm		12	12			50
75078	12mm						55
75079	13mm						65
75080	14mm	20					

UNE 16501:2009 (ISO 1711-1) Cr-V DIN 3124

**1/4"**

Inch.



1.000V  
IEC 60900

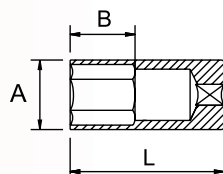

COD	AF	L mm	A	B	gr.		
75085	3/16"	48	9,0	8,0	33	10	
75086	7/32"		10				
75087	1/4"		11				
75088	9/32"		13	10			
75089	5/16"		14				
75090	11/32"		17				
75091	3/8"		19				
75092	7/16"		12	12			55
75093	1/2"						65
75094	9/16"						21

UNE 16501:2009 (ISO 1711-1) Cr-V DIN 3124

**LONG SOCKET WRENCHES 1/4"**

**1/4"**

Inch.



1.000V  
 IEC 60900

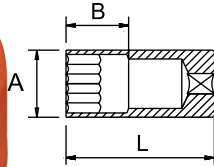

COD	AF	L mm	A	B	gr.	
75100	5/32"	48	7,0	8,0	33	10
75101	3/16"		9,0			
75102	7/32"		10			
75103	1/4"		11	10	35	
75104	9/32"		13			
75105	5/16"		14			
75106	11/32"		14	12	46	
75107	3/8"		17			
75108	7/16"		19			
75109	1/2"		21			
75110	9/16"	21	21	65		

UNE 16501:2009 (ISO 1711-1) Cr-V DIN 3124

**TECHNICAL SPECIFICATIONS**

<b>MATERIAL</b>	Socket wrenches	Cr-V
	Isolation	PVC
<b>MINIMUM HARDNESS</b>	39 HRc	
<b>FINISH</b>	Isolated orange RAL 2009	

**REVERSIBLE RATCHET HANDLE**



1.000V  
 IEC 60900

COD	AF	L mm	gr.		
73687	1/4"	124	140	6	1

**EXTENSION**



1.000V  
 IEC 60900

COD	AF	L mm	gr.		
73244	1/4"	50	28	5	1
73245		100	52		
75204		150	80		

**EXTENSION WITH HANDLE**



1.000V  
 IEC 60900

COD	AF	L mm	gr.		
73256	1/4"	270	150	5	1





**T HANDLE**



COD					
73243	1/4"	170	140	6	1

**HEXAGONAL SOCKET**





COD				
73250	3,0	16	10	1
73251	4,0	18		
73252	5,0	20		
73253	6,0	22		
73254	7,0	24		

**SOCKET WRENCHES SETS 1/4"**

**1/4"**  
 6 Pcs.



COD		pcs.	
79067	51079	6	850

Pcs.	Description	Composition
1	Ratchet 1000V	73246 (1/4")
4	Sockets 1000V	8-10-12-13 mm (1/4")
1	Hexagonal sockets 1000V	5 mm (1/4")



**SOCKET WRENCHES SETS 1/4"**

**1/4"**  
 10 Pcs.

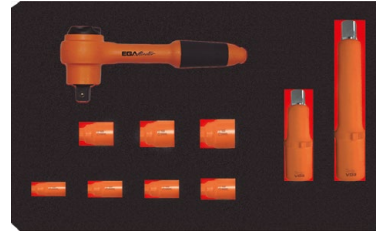

<b>COD</b>		<b>pcs.</b>		<b>Kg.</b>
79475	51079	10	inch	1

Pcs.	Description	Composition
1	Ratchet 1000V	73246 (1/4")
2	Extension 1000V	73244 / 73245 (1/4")
7	Sockets 1000V	3/16", 1/4", 5/16", 3/8", 7/16", 1/2", 9/16"

**1/4"**  
 10 Pcs.  
 LONG SOCKETS



<b>COD</b>		<b>pcs.</b>		<b>Kg.</b>
79476	51079	10	inch	1.2

Pcs.	Description	Composition
1	Ratchet 1000V	73246 (1/4")
2	Extension 1000V	73244 / 73245 (1/4")
7	(L.S.) Sockets 1000V	3/16", 1/4", 5/16", 3/8", 7/16", 1/2", 9/16"

**1/4"**  
 11 Pcs.



<b>COD</b>		<b>pcs.</b>		<b>gr.</b>
79068	51079	11	mm	950

Pcs.	Description	Composition
1	Ratchet 1000V	73687 (1/4")
9	Sockets 1000V	6-7-8-9-10-11-12-13-14 mm (1/4")
1	Hexagonal sockets 1000V	5 mm (1/4")

SOCKET WRENCHES SETS 1/4"

**1/4"**  
16 Pcs.

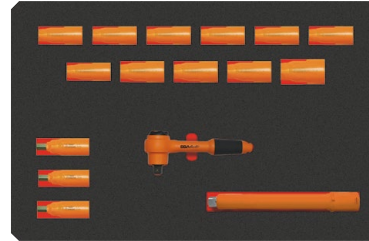

**COD**



**pcs.**



79069

51053

16

mm

1,5

Pcs.	Description	Composition
1	Ratchet 1000V	73246 (1/4")
1	Extension 1000V	73245 (1/4")
11	Sockets 1000V	4-5-6-7-8-9-10-11-12-13-14 mm (1/4")
3	Hexagonal sockets 1000V	4-5-6 mm (1/4")

**1/4"**  
19 Pcs.

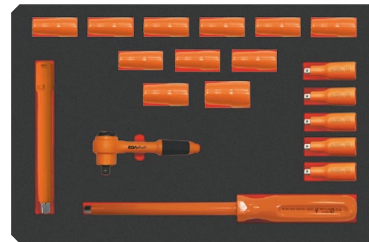

**COD**



**pcs.**



73014

51053

19

mm

2

Pcs.	Description	Composition
1	Ratchet 1000V	73246 (1/4")
1	Extension 1000V	73245 (1/4")
1	Extension with handle 1000V	73256 (1/4")
11	Sockets 1000V	4-5-6-7-8-9-10-11-12-13-14 mm (1/4")
5	Hexagonal sockets 1000V	3-4-5-6-7 mm (1/4")

**1/4"**  
21 Pcs.  
LONG AND  
SHORT  
SOCKETS

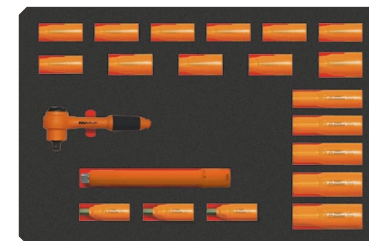

**COD**



**pcs.**



79070

51053

21

mm

1,8

Pcs.	Description	Composition
1	Ratchet 1000V	73246 (1/4")
1	Extension 1000V	73245 (1/4")
11	Sockets 1000V	4-5-6-7-8-9-10-11-12-13-14 mm (1/4")
5	(L.S.) Sockets 1000V	8-10-12-13-14 mm (1/4")
3	Hexagonal sockets 1000V	4-5-6 mm (1/4")